



2 in 1 Cordless Handstick

**PLEASE READ THE
MANUAL CAREFULLY
BEFORE USING AND
KEEP IT PROPERLY FOR
FUTURE USE**

Warning notices: Before using this product, please read this manual carefully and keep it for future reference.

The design and specifications are subject to change without prior notice for product improvement. Consult with your dealer or manufacturer for details.

version 01

INSTALLATION INSTRUCTIONS USER GUIDE

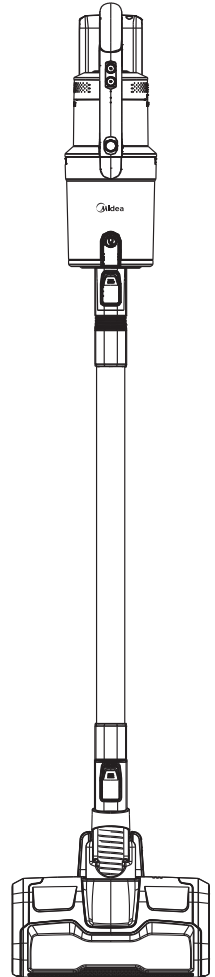

MVC-V18PR

01

STRUCTURE OF THE PRODUCT

Assembly and other parts instruction

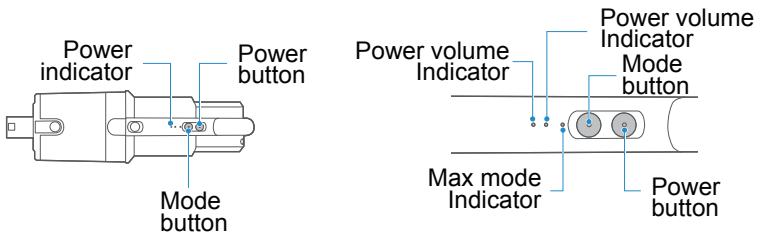
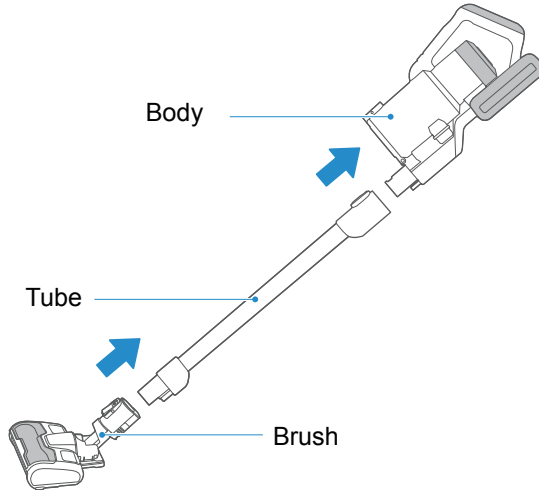

Accessories list:

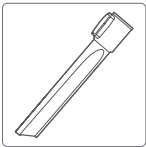

**Crevice
Nozzle**

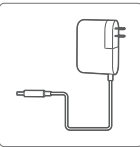

Adaptor

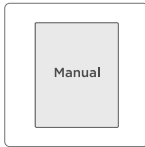

**Instruction
Manual**

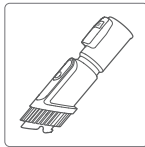

2 in 1 brush

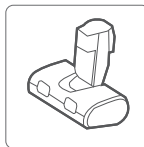

**Turbo bed
brush**

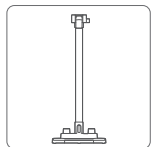

**Storage
rack**

Tips:

When cleaning the high places, please assemble the accessories on tube.

02

HOW TO USE

Operation 1:

Battery charging:

Tips:

Battery is not full when leaving factory, please remember to charge up before first usage.

No. Operation instruction

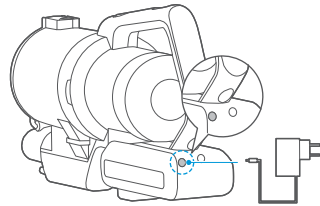

1 Put the body on horizontal surface.

Connect the adaptor to charging port
on battery pack and plug the adaptor to socket.

When charging, power indicator will twinkle continuously.

1min after charging up, indicator will shut off.

2 Charging time : 4-6h

Discharging time : Max Mode: ≥ 10 Mins
Middle Mode: ≥ 20 Mins
Low Model: ≥ 45 Mins

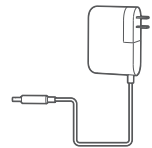

Operation 2:

Cleaning:

Note:

To avoid the air flue being blocked, please clean the big particle waste. (such as paper, cloth and others).

No. Operation instruction

- 1 Knob down “Power button” to start
- 2 Knob down “Power button” again to stop
- 3 When only one power indicator is on and twinkle, please charge it.

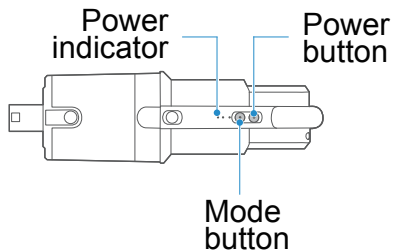

Operation 3

Wall mount assembly and usage:

1. Wall mount assembly

When not using the cleaner, please store the cleaner on mount.

2. Choose the storage rack

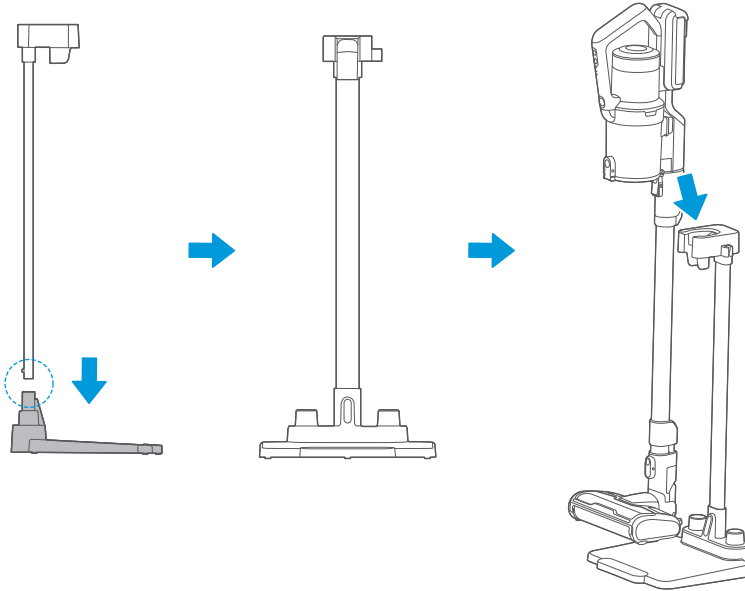

1. Installation of the storage shelf: install the receiving buckle assembly and the storage base as shown in the diagram, and place the installed storage shelf assembly vertically on the horizontal surface as shown in the right picture;
2. Placement of the whole machine: Before placing the whole machine on the storage rack components, please confirm again whether the placement position is horizontal, and ensure that the whole machine has been closed and stopped working. Gently place the whole machine on the slot position of the storage rack as shown in the figure below, and leave after the whole machine is placed smoothly.

Operation 4

Replace Battery

Tips:

1. Laypeople don't disassemble battery please.
2. Battery must be replaced and repaired by professional after-sales service personnel.

Operation 5

Clean and maintain cleaner

Dust cup disassembly and clean

Tips:

To keep the suction power of cleaner, please clean the dust in it regularly.

1. Push the locker button, open the bottom cover and release dust

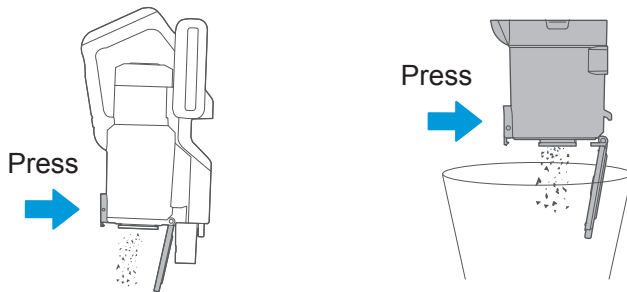

2. Knob down the dust cup release button, take down the cup

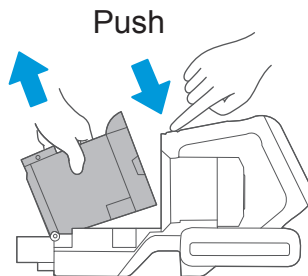

3. Take out the cyclone from dust cup

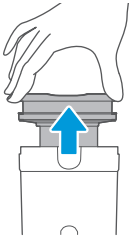

4. Disassemble cyclone and clean, all parts are washable.

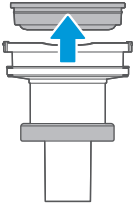

5. After airing all parts completely, assemble them according to disassembly steps.

Operation 6

Clean and maintain motorized brush

Note:

1. To avoid affect the normal operation of brush, when roller brush and wheels is entangled or dusty, please clean and maintain them.
2. When disassemble and main brush, please make sure it's not working

1. Push button and take off the brush.

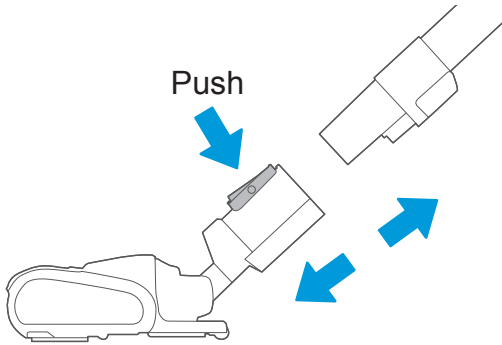

2. Open the gland of brush, then take out the roller brush and clean ,
After cleaning it completely, assemble them according to
disassembly steps.

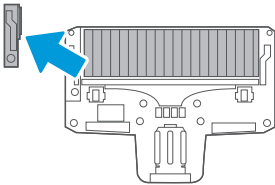

Open the gland

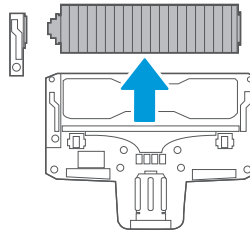

Take out roller brush

Tips:

Don't suggest to wash the brush.

If the brush was tangled by hair, please scissor or knife to clean.